

INITIAL RECEIPT

United States Department of the Interior
Bureau of Land Management
 DIV OF LANDS, MINRLS & ENERGY
 ONE N CENTRAL AVE
 PHOENIX, AZ 85004 -4427
 Phone: 602-417-9200

Receipt

No: 4852414

Transaction #: 4980877	
Date of Transaction: 12/16/2020	
CUSTOMER:	
PYRAMID MINING INC 27 W MAIN ST APT 9 SANTAQUIN,UT 84655-5642 US	

LINE #	QTY	DESCRIPTION	REMARKS	UNIT PRICE	TOTAL
1	1.00	LOCATABLE MINERALS / MINING CLAIMS-NEW,UNADJUD, ONE OR MORE AUTH NOS / NEW MINING CLAIM PROCESSING FEE CASES: AMC462362/\$20.00		- n/a -	20.00
2	1.00	LOCATABLE MINERALS / MINING CLAIMS-NEW,UNADJUD, ONE OR MORE AUTH NOS / NEW MINING CLAIMS LOCATION FEE CASES: AMC462362/\$40.00		- n/a -	40.00
3	1.00	LOCATABLE MINERALS / MINING CLAIMS-NEW,UNADJUD, ONE OR MORE AUTH NOS / NEW MINING CLAIMS MAINTENANCE FEE CASES: AMC462362/\$165.00		- n/a -	165.00
TOTAL:					\$225.00

PAYMENT INFORMATION			
1	AMOUNT:	225.00	POSTMARKED: N/A
	TYPE:	CHECK	RECEIVED: 12/15/2020
	CHECK NO:	018285931	
	NAME:	PYRAMID MINING INC 27 W MAIN ST APT 9 SANTAQUIN UT 84655-5642 US	

REMARKS

ENTERED
 DEC 29 2020
 BY: *ML*

This receipt was generated by the automated BLM Collections and Billing System and is a paper representation of a portion of the official electronic record contained therein.

CORRESPONDENCE

TRANSFERS

MAINTENANCE FEES
WAIVERS
POL/NOI

MISCELLANEOUS

Copy Certificate

State of Utah)

County of Salt Lake) §

On this 7 day of December, in the year 20 20, I certify that the preceding or

attached document, is a true, exact, complete and unaltered photocopy made by me of

MELLO pyramid mining inc. claim
Description of Document

Presented to me by the document's custodian, Manuel Escoto

Name of Custodian

and that, to the best of my knowledge, the photocopied document is neither a public record nor a publicly recorded document, certified copies of which are available from an official source other than a notary.

S
E
A
L

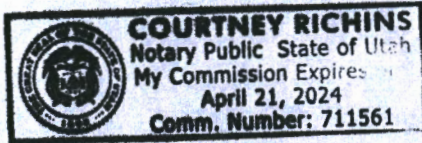

Courtney Richins
Signature of Notary Public

April 21, 2024
Commission Expires

Description of Attached Document

Title or Type of Document: Mello pyramid mining inc

Document Date: 12.7.20 Number of Pages: 1

Signer(s) Other Than Named Above: _____

RECEIVED
BENNETT STATE OFFICE
2020 DEC 15 A 9 00
PHOENIX, ARIZONA

AMC462362

**LOCATION NOTICES
AMENDMENTS
STATUS SHEET
GEO REPORT/MTP**

MINING CLAIM STATUS REPORT - Assessment Year 2020-2021

Data Entered: 12/29/2020 mcl

MTP Checked By: TCU
GEO Checked By: TCU

LEAD SERIAL NUMBER: AMC 462362 thru AMC

NUMBER OF CLAIMS & TYPE:

1 LODE
____ PLACER
____ ASSOCIATION PLACER
____ MILL SITE
____ TUNNEL SITE

CHARGES:

Processing Fee @ \$20 = \$ 20
Location Fee @ \$40 = \$ 40
Maintenance Fee @ \$165 = \$ 165
Add'l Maint Fee for Assoc Placer = \$ _____
SUBTOTAL \$ 225
Other Fees \$ _____
Other Fees \$ _____
TOTAL \$ _____

TOTAL ACREAGE: _____ Per Claim
(Placer Only)

NUMBER OF LOCATORS: _____

DOCUMENTS RECEIVED VIA: Over-the-Counter [] Mail [] **TIMELY FILED:** Yes [] No []

LEGAL DESCRIPTION: T 2N R 1E SEC 11
T _____ R _____ SEC _____
T _____ R _____ SEC _____
T _____ R _____ SEC _____
T _____ R _____ SEC _____

BLM [] FOREST SERVICE [] _____ SUBJ TO PL 359: Yes [] No []
WILDERNESS AREA [] _____

SPLIT ESTATE: N/A [] SX [] PX [] OTHER [] _____
SRHA [] Was proper Notice filed if located on SHRA Land? Yes [] No []

RECONVEYED MINERALS ON BLM LAND REQUIRE OPENING ORDER FROM 1944 TO 1993:

Open to Entry On _____ N/A []

COMMENTS/STATUS: VOID [] PARTIALLY VOID [] PVT MINERALS [] WITHDRAWN LANDS []
OTHER [] _____

[] Claimant acknowledges that portions of the following claim(s) site(s) may be void or voidable.

Printed Name of Claimant _____ Signature of Claimant _____

*****FINAL ADJUDICATION*****

DATE _____ INITIALS _____

ANC462362

LOCATION NOTICE FOR LODE MINING CLAIM

NOTICE IS HEREBY GIVEN that the MEL 1'0

lode mining claim has been located
by Pyramid Mining Inc whose current mailing
address is 27 W MAIN ST. # 9
SANTAQUIN, UT. 84655

BLM
Date
Stamp

RECEIVED
BLM AZ STATE OFFICE
2020 DEC 15 A 9 00
PHOENIX, ARIZONA

The general course of this claim is NORTH TO SOUTH and it is situated in MOHAVE
County, Arizona. This claim is 1000 feet in length and 600 feet in width. This claim runs
from the location monument on which this location notice is posted approximately 500 feet in a
WEST direction to the WEST end line and 500' feet in a EAST direction to the
EAST end line. This claim is marked by six monuments, one at each corner and one at the center of each
end line of the claim.

The location monument on which this notice is posted is situated within Section 11, Township 2
NORTH Range 1 E, Gila Salt River Base and Meridian, Arizona and this claim encompasses portions
of the following quarter section (s), section (s), Township (s) and Range (s) NORTH EAST QUARTER,
SECTION 11, TOWNSHIP 2 NORTH, RANGE 1 EAST

Gila Salt River Base and Meridian, Arizona.

The locality of this claim with reference to some natural object or permanent monument and additional information
(if any) concerning its locality are as follows: FROM NORTH EAST CORNER MONUMENT T23 N R16 W
OF SECTION 11, THE DISCOVERY MARKER IS - 883 FT SOUTH - 2910 FT EAST
TO CENTER w/MONUMENT

DATED AND POSTED on the ground this 7th day of December, 2020.
LOCATOR (s) [Signature] Manuel Escoto

AMC462362

Form MCF100
Revised July 2005

MEL 1.0

PYRAMID MINING INC.

27 WEST MAIN ST. #9

SANTAQUIN UT. 84655

NOT A

County of

On this day of

Personally appeared before me

who is personally known to me

and whose identity I verified on the basis of

whose identity I verified on the production of

a credible witness

to be the signer of the foregoing document, and relates

acknowledged its contents to be true and correct

CLAIM DIMENSIONS

A - 400'

B - 600'

C - 300'

D - 600'

X - CENTER MONUMENT

SECTION 3

SECTION Z

SECTION 1

SECTION MARKER
T23N
R16W

NORTHWEST QUARTER

NORTHEAST QUARTER

883' SOUTH FROM SECTION MARKER

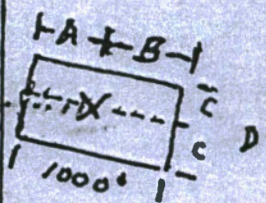

2910 FT FROM WEST SECTION BOUNDARY TO CENTER MONUMENT

SECTION 11

SECTION 10

SECTION 12

SOUTHWEST QUARTER

SOUTHEAST QUARTER

SECTION 15

SECTION 14

SECTION 13

SOUTH

2020 DEC 15 A 9 00

RECEIVED

ANC462362



LR2000 Internal

CR Geographic Report with Land

Download User Guide (pdf)

Purpose: This report produces a geographic listing of case information based on retrieval by Meridian/Township/Range. This report format will display the case type, case disposition, meridian, township, range, section, survey type, survey number, surface management agency, pending actions, serial number, and total case acres.

To refresh the query, do a **Ctrl-R**. It resets the page and clears any criteria fields that may have entries.



No Results

The specified criteria didn't result in any data. This is often caused by applying filters and/or selection steps that are too restrictive or that contain incorrect values. Please check your analysis filters and selection steps, and try again. The filters or selection steps currently being applied are shown below.

Filters

Disposition is equal to **AUTHORIZED, CANCELLED, EXPIRED, PENDING, REJECTED, RELINQUISHED, WITHDRAWN**

and Meridian Township Range Section is equal to **14 0020N 0010E 011**

and Admin State is equal to **AZ**



- Expected delivery date specified
- Most domestic shipments insured
- USPS Tracking® included for free
- Limited international insurance available
- When used internationally, a flat rate fee applies

*Insurance does not cover certain items. See Domestic Mail Manual at <http://pe.usps.gov>
 ** See International Mail Manual at <http://pe.usps.gov>

FLAT RATE ENVELOPE
 ONE RATE ■ ANY WEIGHT

TRACKED ■ INSURED



EP14F May 2020
 OD: 12 1/2 x 9 1/2

To schedule free Package Pickup, scan the QR code.



USPS.COM/PICKUP

Retail

POSTAGE PAID
\$7.75

Origin: 84065
 12/08/20
 4874460165-15

PRIORITY MAIL 2-DAY®

0 Lb 1.80 Oz
 1004

EXPECTED DELIVERY DAY: 12/11/20

C041

SHIP TO:
 1 N CENTRAL AVE
 STE 800
 Phoenix AZ 85004-4427

USPS TRACKING® NUMBER



9505 5152 4039 0343 5927 36

PRESS FIRMLY TO SEAL

**PRIORITY MAIL
 FLAT RATE ENVELOPE
 POSTAGE REQUIRED**

FROM:

Manuel Escoto
 27 W. Main St. 9
 Santaquin UT 84655

TO:

Bureau of Land Mgmt.
 1 N Central Ave Ste 800
 Phoenix AZ 85004

PHOENIX, ARIZONA

2020 DEC 15 A 9 01

RECEIVED
 BEM AZ STATE OFFICE

This packaging is the property of the U.S. Postal Service® and is provided solely for use in sending Priority Mail® and Priority Mail International® shipments. Misuses may be a violation of U.S. Postal Service laws. All rights reserved.